

FIRE RATED SD LOFT HATCH

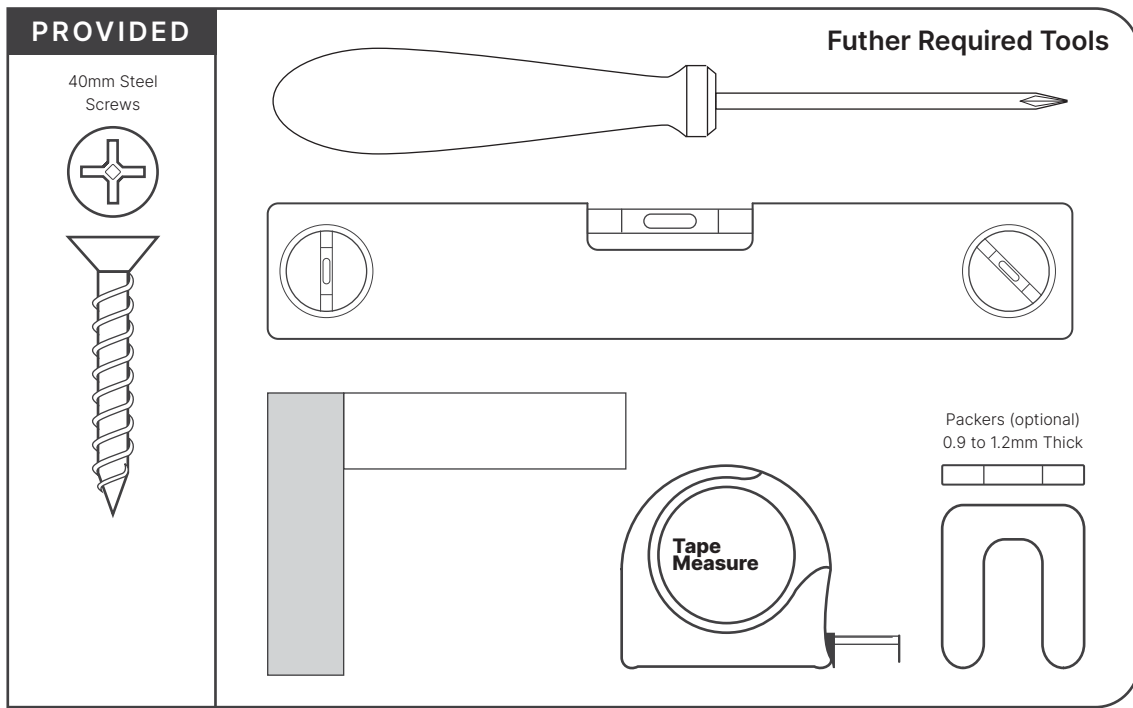

Fitting Instructions

1

Form a suitable opening in the ceiling and between the joists according to the sizing table below:

Product Size	Structural Opening Size	Fireboard Lining
550 × 550mm	555 × 555mm	9.5mm
550 × 800mm	560 × 805mm	9.5mm
550 × 755mm	555 × 755mm	9.5mm
600 × 600mm	605 × 605mm	9.5mm
600 × 900mm	605 × 905mm	9.5mm

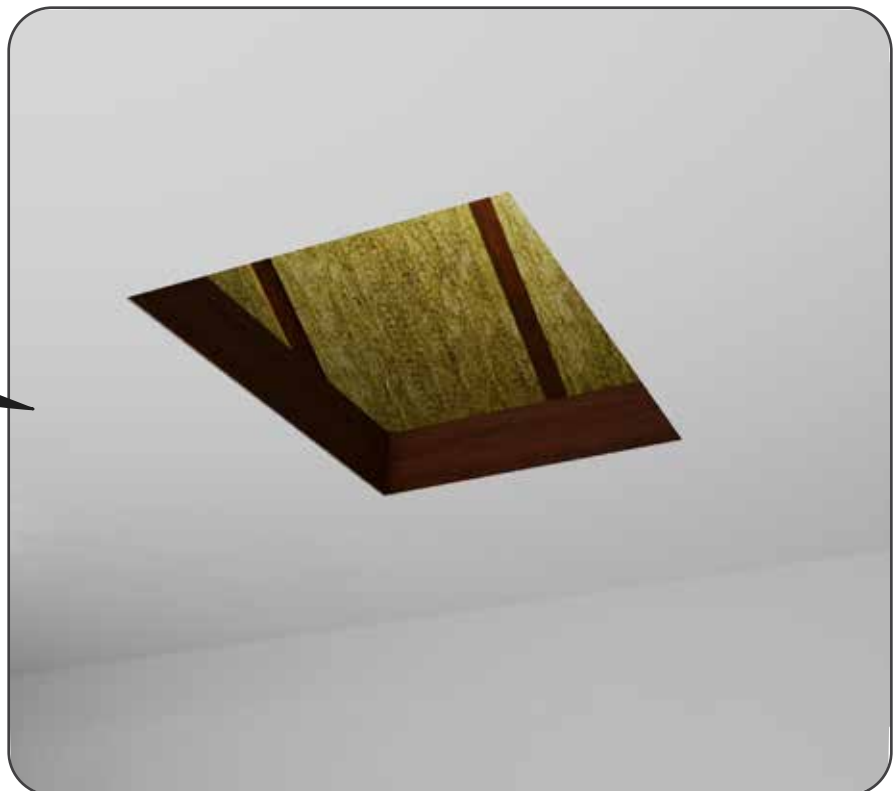
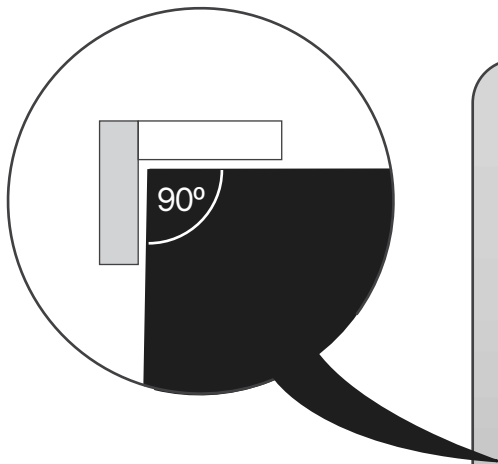

2

Line the four timber faces with 9.5mm thick plasterboard to 60mm high (for protection against heat from the metal frame).

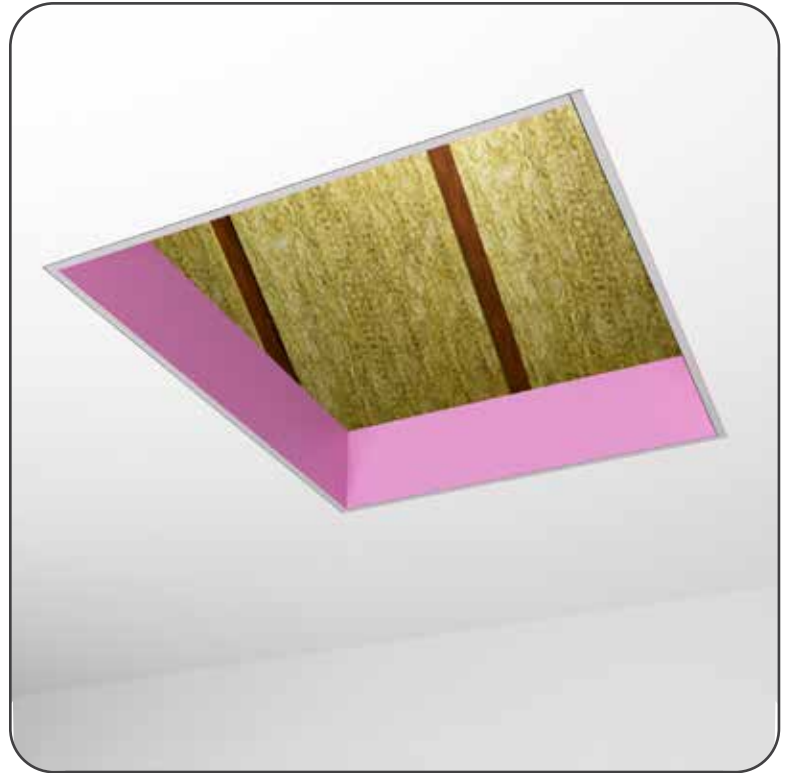
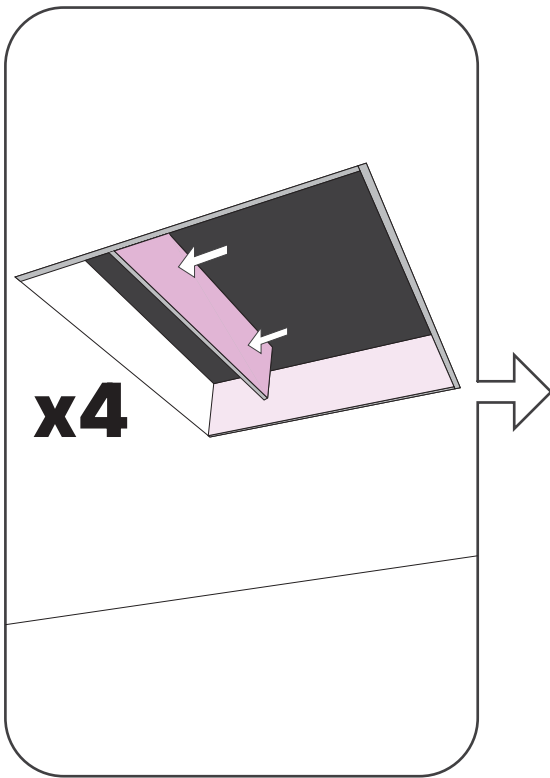

3

Open the hatch 90° and locate the frame into the prepared structural opening.

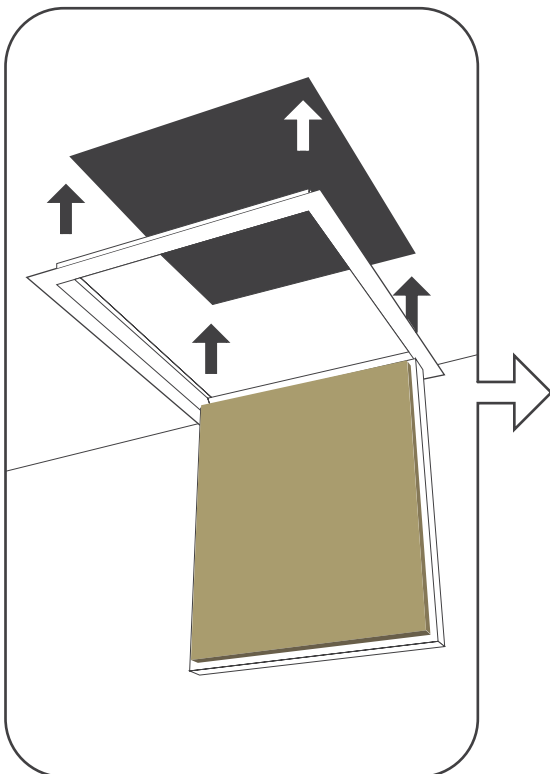

Push the frame tightly against the ceiling to engage the seal between the frame and the ceiling.

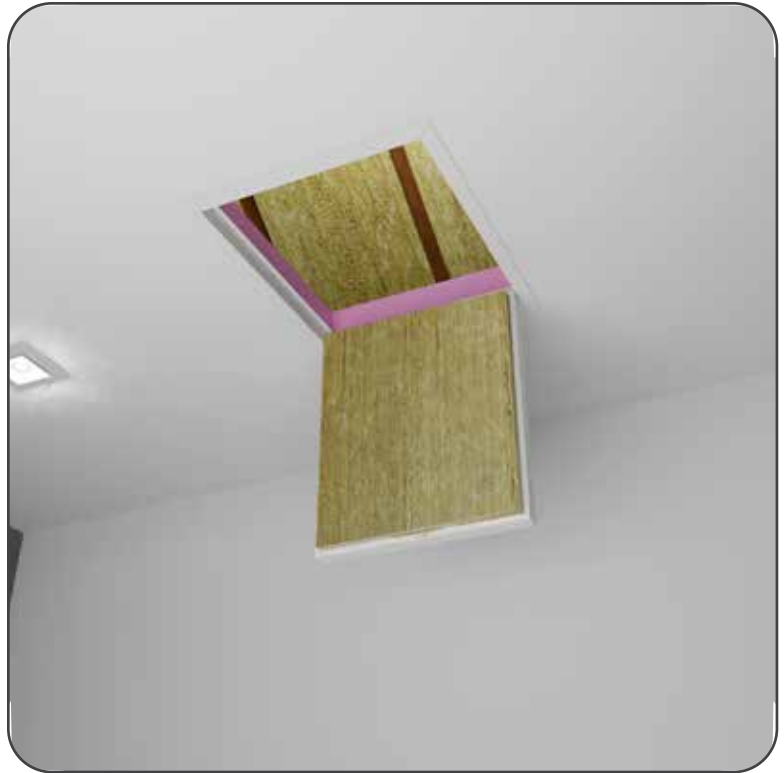
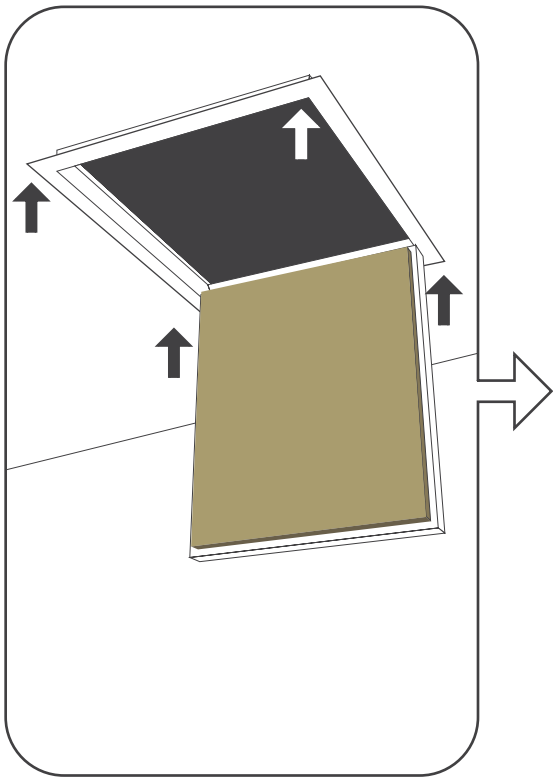

Fix the frame using all 6 screws through the pre-punched holes, found on the sides of the frame (do not fully tighten).

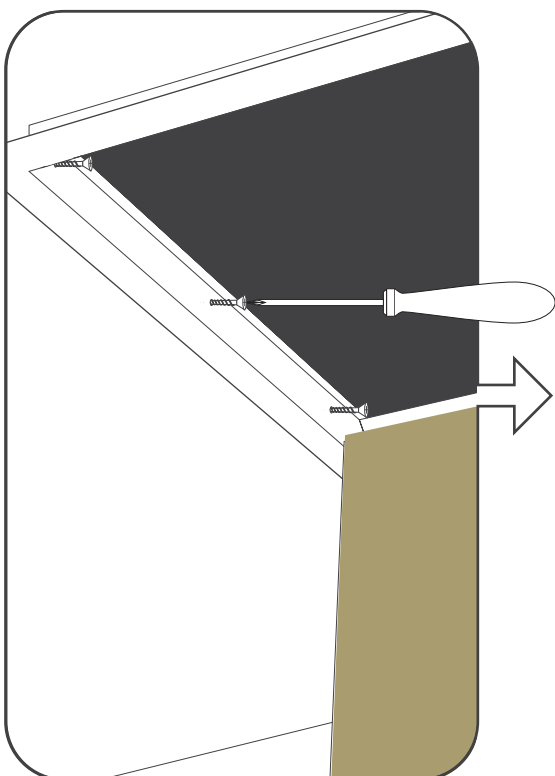

Before fully screwing into position, check the frame as square by ensuring the diagonals are equal.

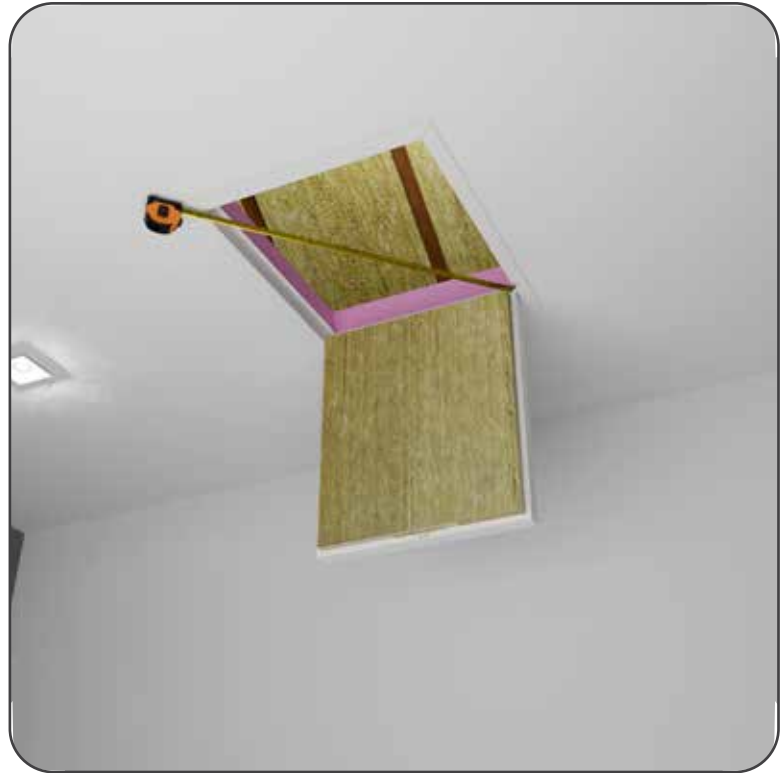
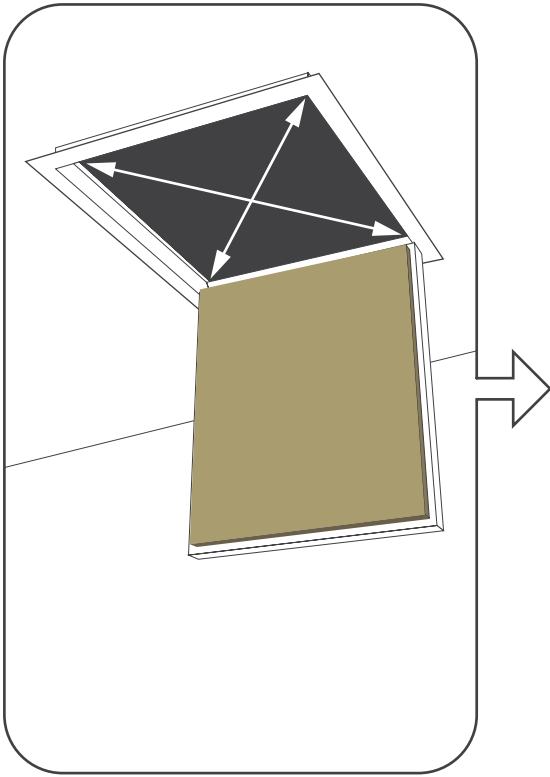

If necessary, add packers behind the frame fixings.

Do not overtighten the screws as this can distort the frame.

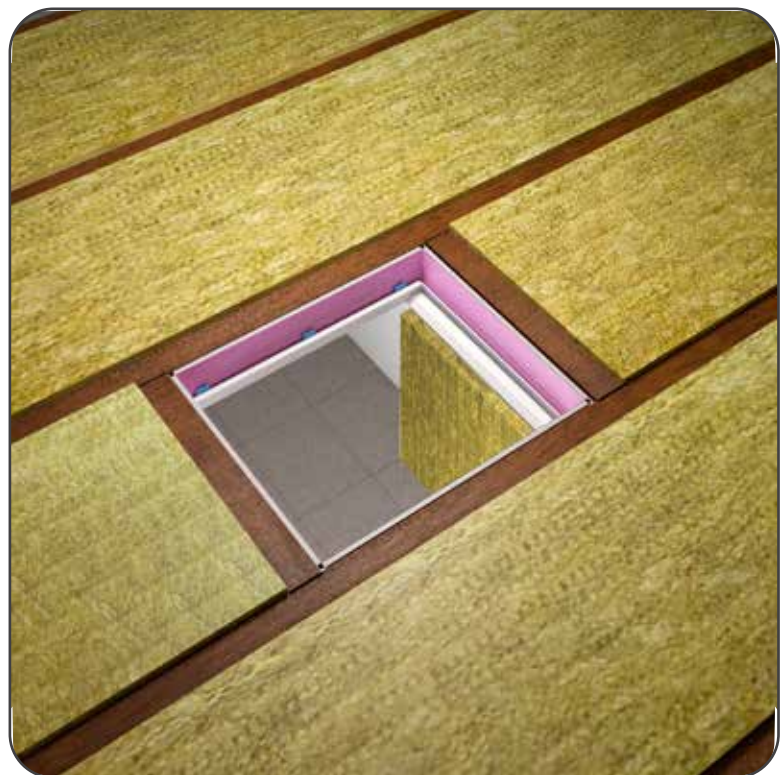
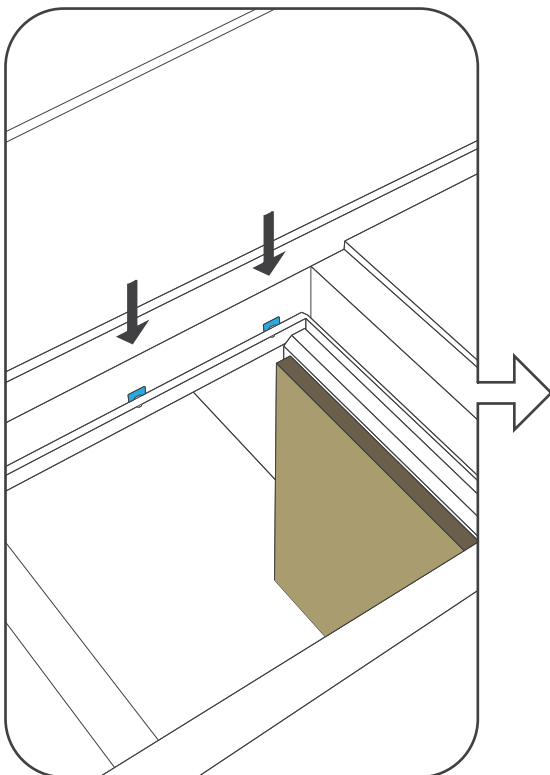

Close the hatch door and put the key into the lock.
Turn the key 90° to secure the door in the closed position.

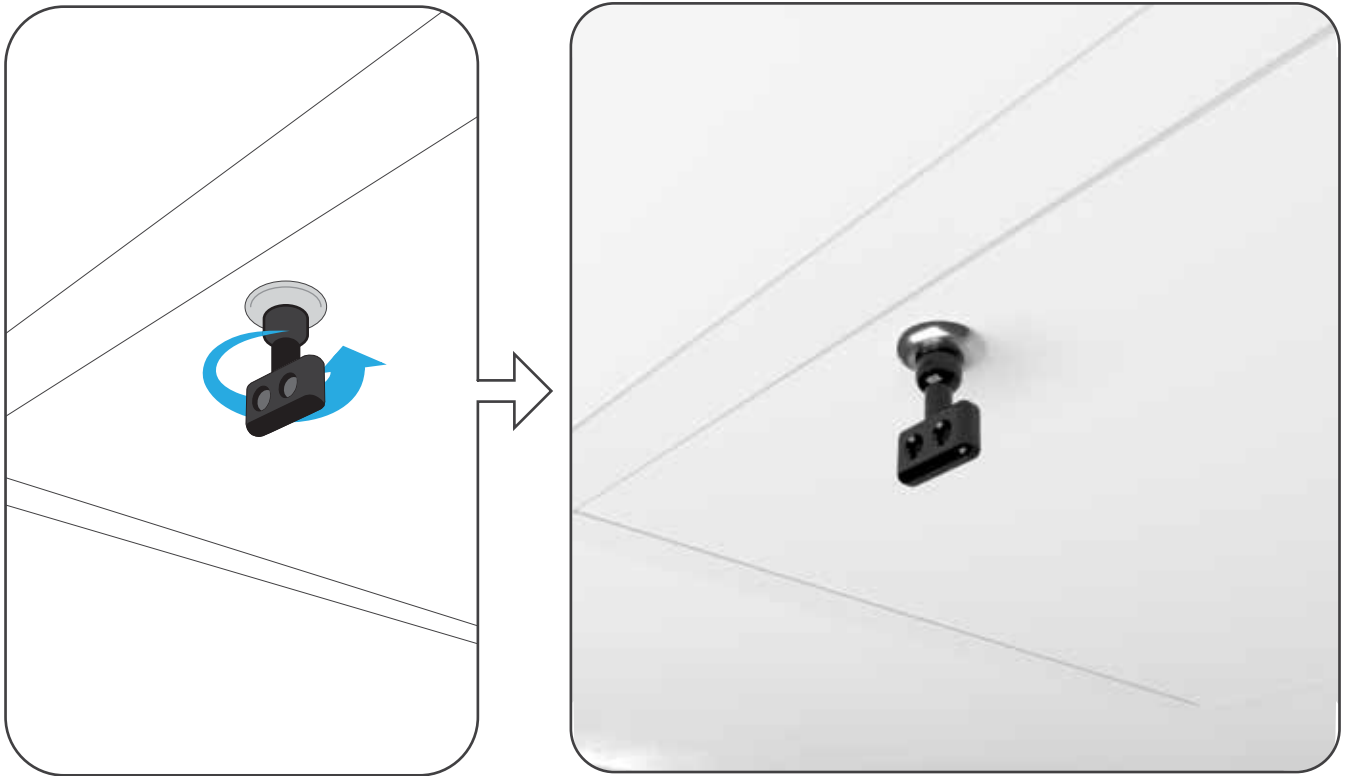

Did you know?

We can make bespoke, fire rated, air tested loft hatches up to a size of 900 × 900mm

For further Information
Call us on
01827 720 830